

COMMUNITY-ENGAGED POST-OCCUPANCY EVALUATION: Hing Hay Park Expansion & Donnie Chin International Children's Park

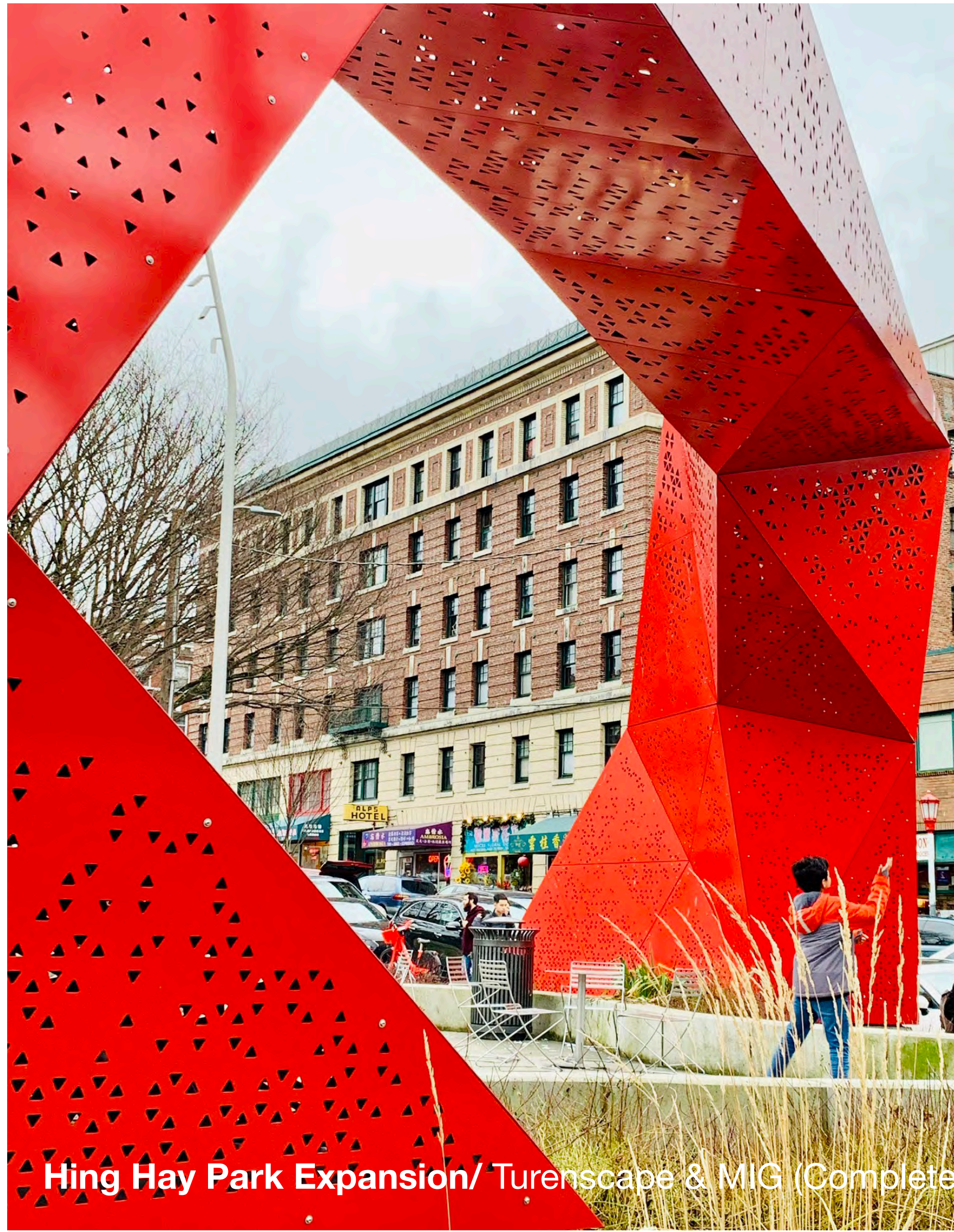

Scan for Full Report



Hing Hay Park Expansion/ Turenscape & MIG (Completed 2018)



Source: Seattle Department of Parks & Recreation

This project performed a community-engaged post-occupancy evaluation of two neighborhood parks—Hing Hay Park and Donnie Chin International Children's Park—in Seattle's historically marginalized Chinatown International District. As projects that involved extensive community outreach and engagement in their expansion and renovation (completed in 2018 and 2012 respectively), this study examines whether and how the parks are currently meeting the community expectations and design intentions. The study found that both parks have performed well to the community expectations and design intentions, specifically aspects of inclusivity, safety, and intergenerational uses. The study also identifies ongoing challenges and areas for improvement, including maintenance and cleanliness as key to perceptions of safety. The role of capacity-building and sustained community engagement processes was highlighted in stakeholder interviews as additional outcomes of the projects. This post-occupancy evaluation is unique for its community capacity-building approach by involving community volunteers and student interns in data collection and mapping and by following up with community stakeholders to learn about their experience with the community engagement process for the projects.



Donnie Chin International Children's Park Renovation: KKL A (Completed 2012)



Scan the QR code on the top right corner for the full report.

Hing Hay Park/ Locations of users & user activities. Left/Right: Weekday Mornings/Afternoons (October 2018)

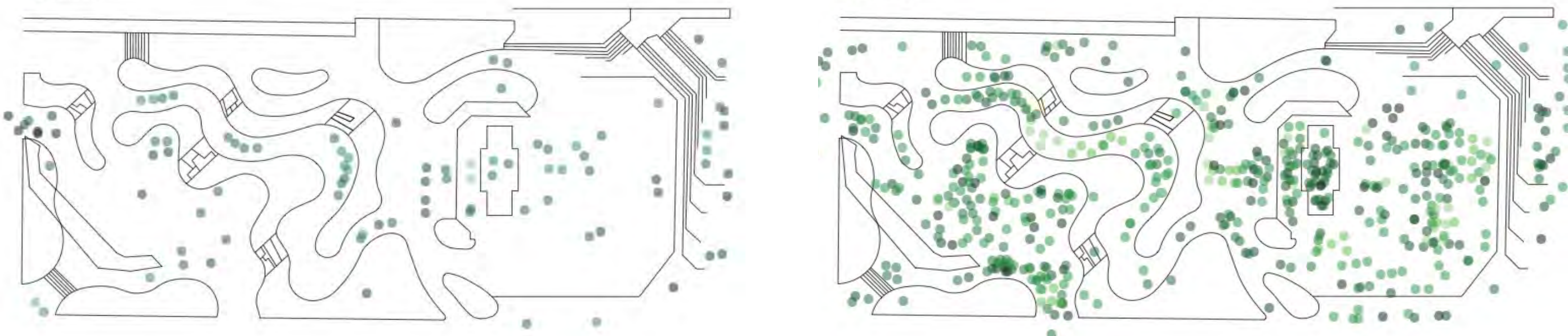

International Children's Park/ Locations of users & user activities. Left/Middle/Right: Weekday Mornings/Afternoons/Evenings (October 2018)



Hing Hay Park/ User movement & circulation. Left/Right: Weekday Mornings/Afternoons (October 2018)

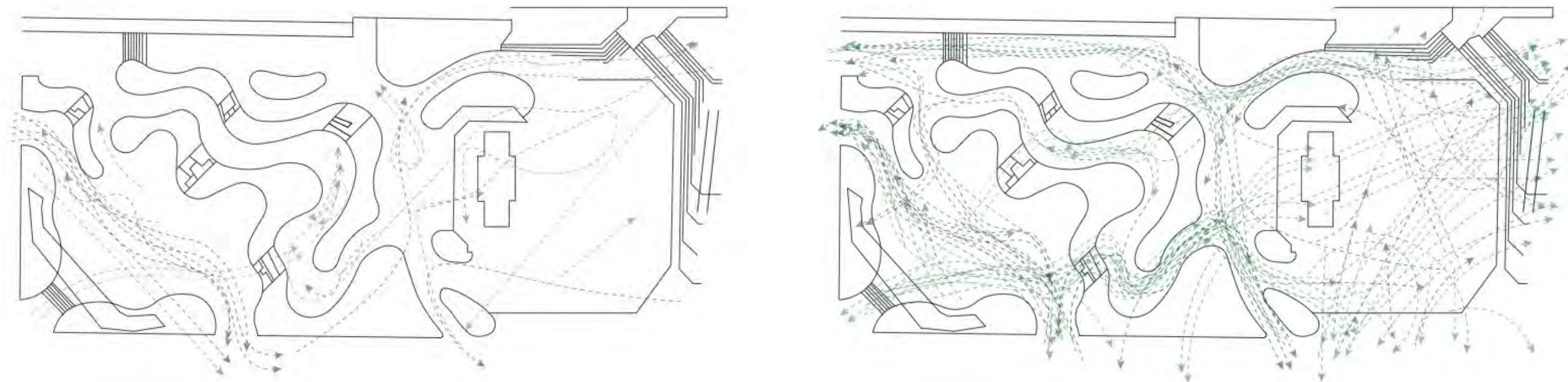

International Children's Park/ User movements & circulation. Left/Middle/Right: Weekday Mornings/Afternoons/Evenings (October 2018)

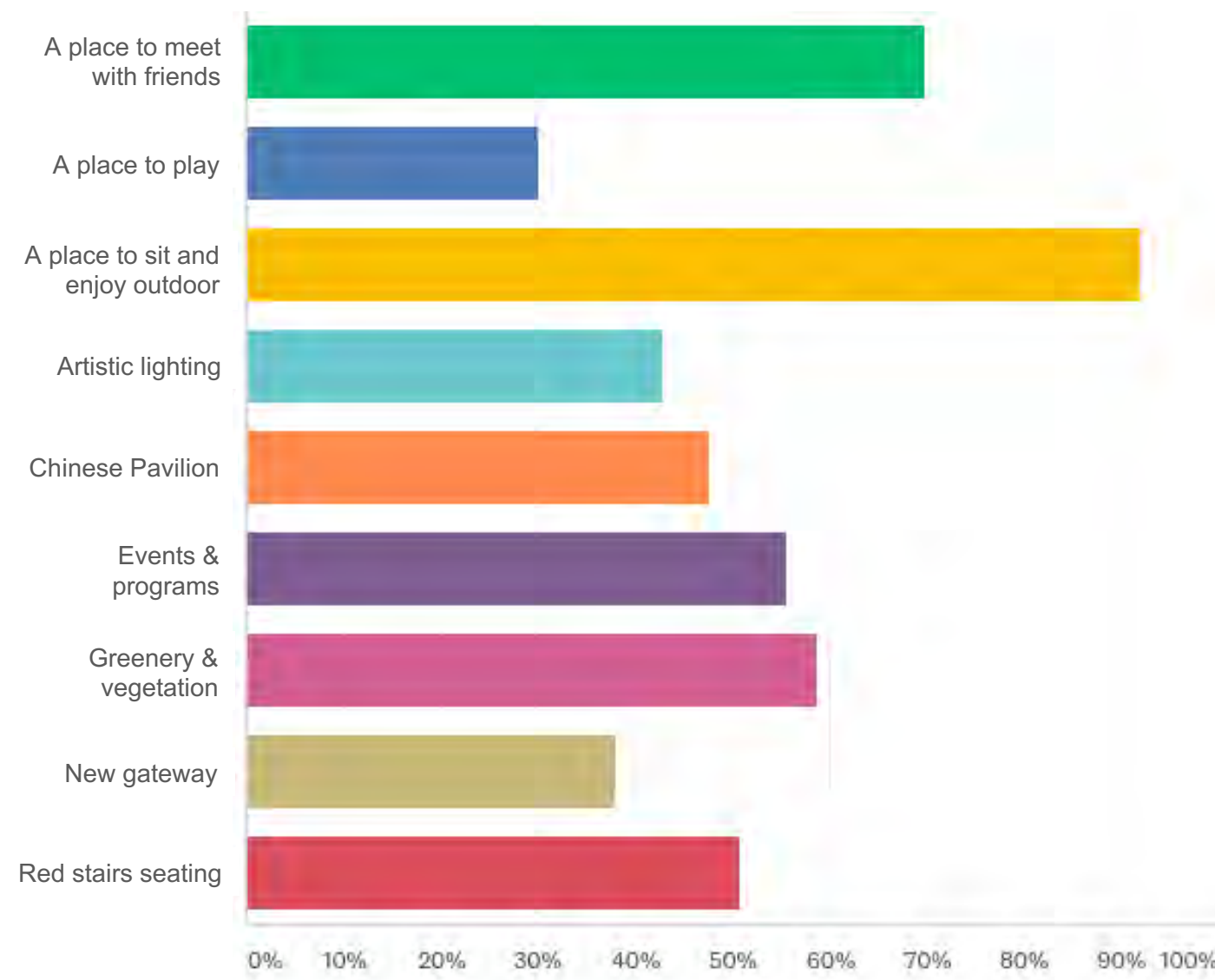
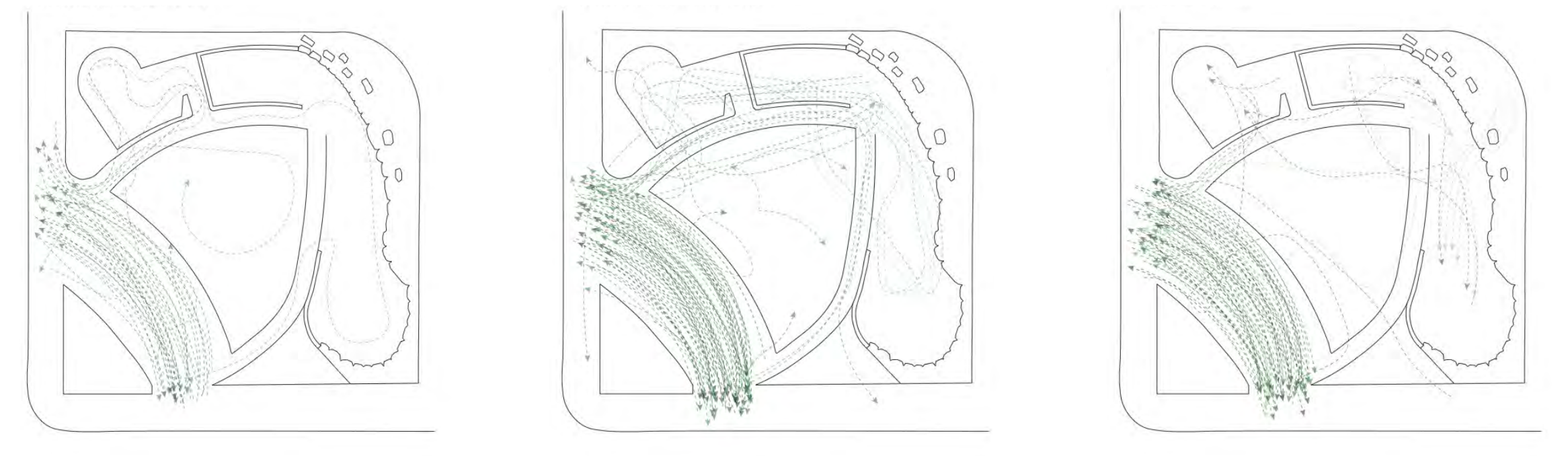

What do you find attractive about the park? (Check all that apply)
Left: HHP (n=63); Right: ICP (n=73)

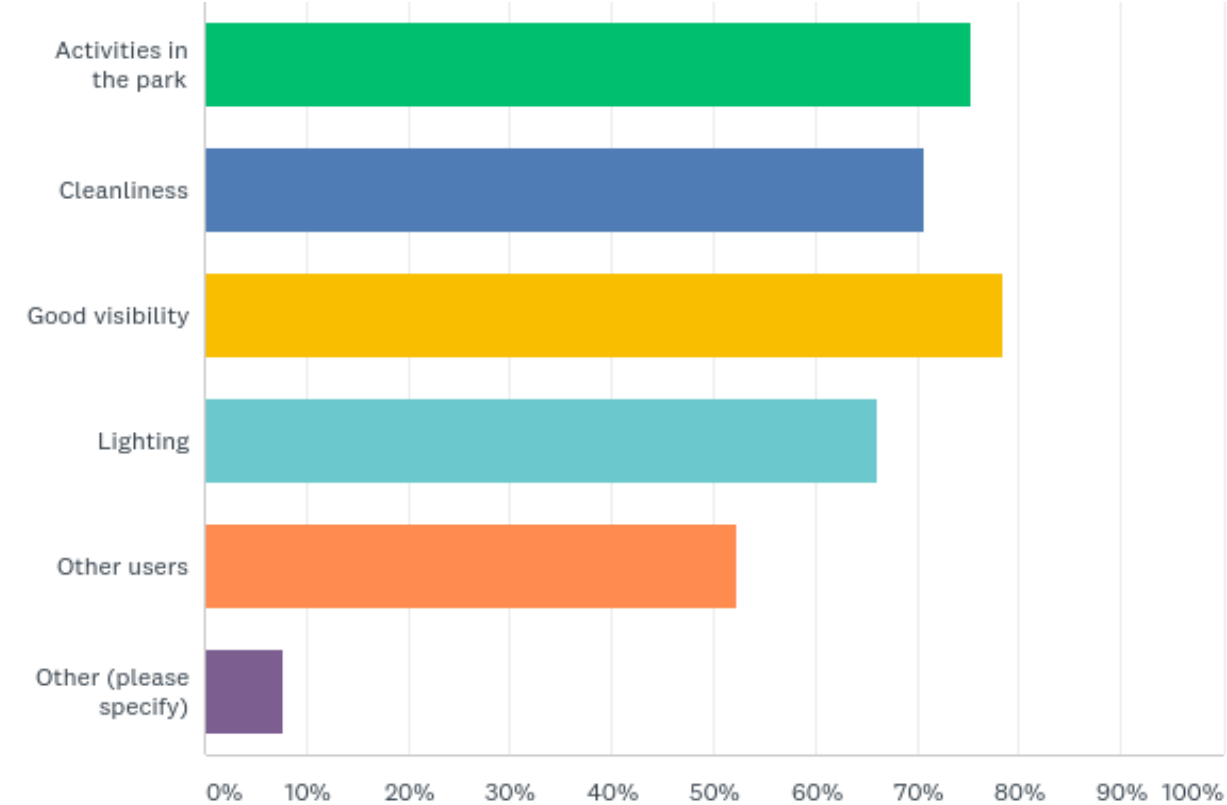
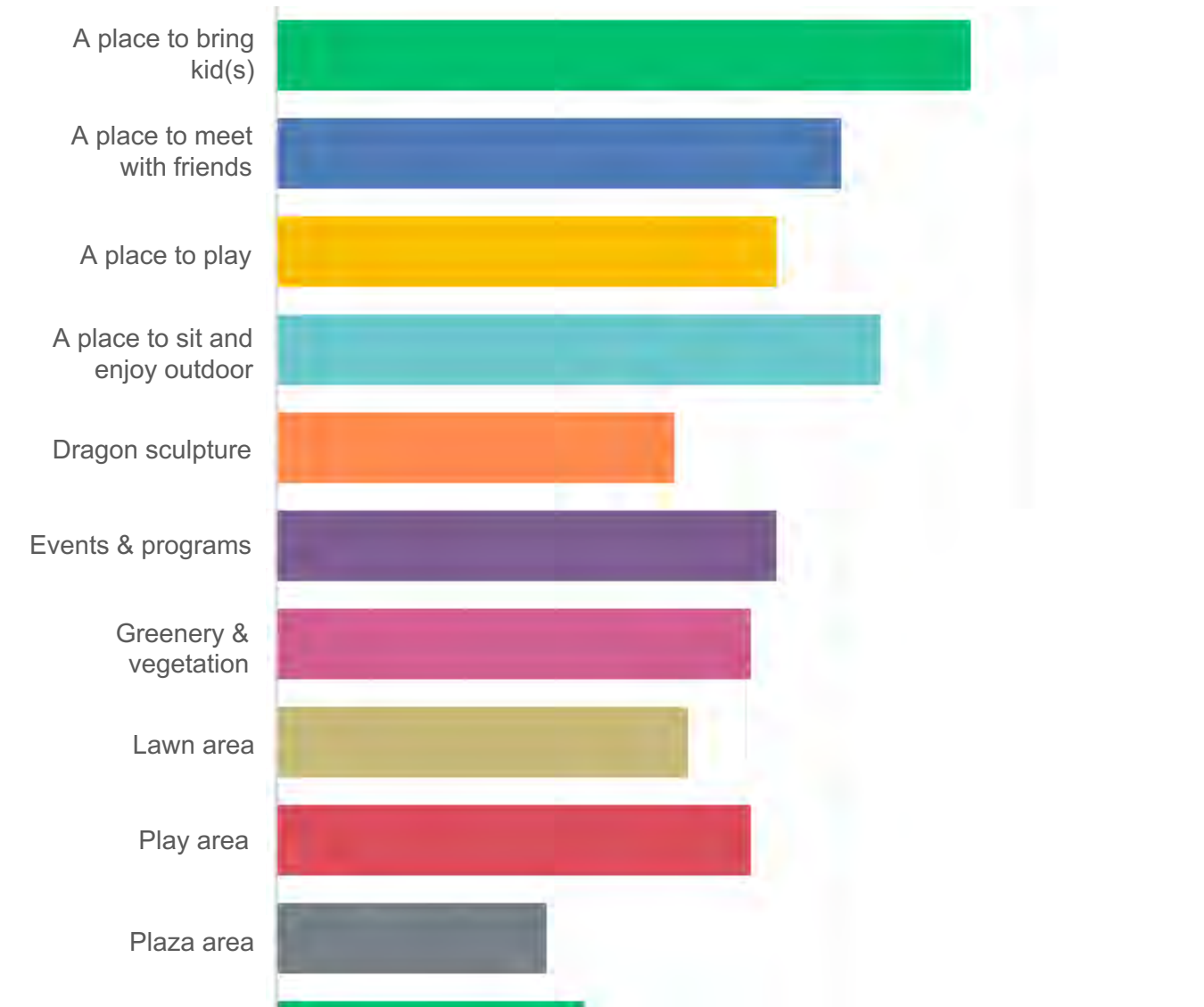

What makes you feel safe in the park? Left: HHP (n=65); Right: ICP (n=69)

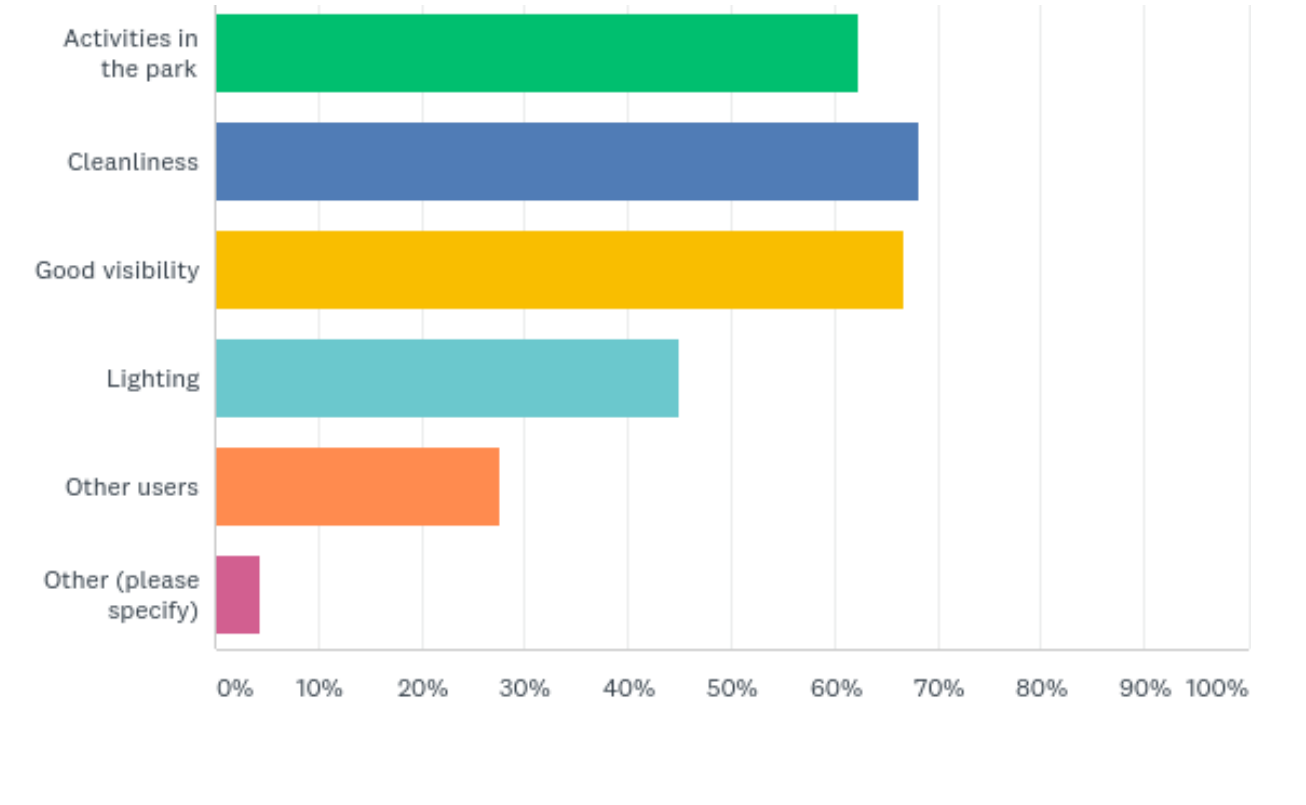

Project Manager: An Huynh/ **Project Consultant:** Jeff Hou/ **Project Interns:** Julie Yuan & Li Tan/ **Advisory Committee:** Kim Baldwin, Pamela Kliment, Christine Lesh, Brice Maryman, Sonny Nguyen, Monisha Singh, Tuck Eng, Liana Woo/ **Project Volunteers:** Robert Lohmann, Neil Kato, Aisling Doyle Wade, Peyton Blackmer, Sarah Lee/ **With the support of the Neighborhood Matching Fund Grant, Seattle Department of Neighborhoods**



SCIDpda

