

OUT IN FRONT:

Justice, Equity, Diversity, Inclusion

Beacon Food Forest
 c/o Food Forest Collective
 16th Ave S & S Dakota St.
 Seattle, WA 98108



Partnered with:
 Seattle Public Utilities (SPU)
 Dept. of Neighborhoods
 P-patch Program
 Seattle Indian Health Board
 Percussion Farms

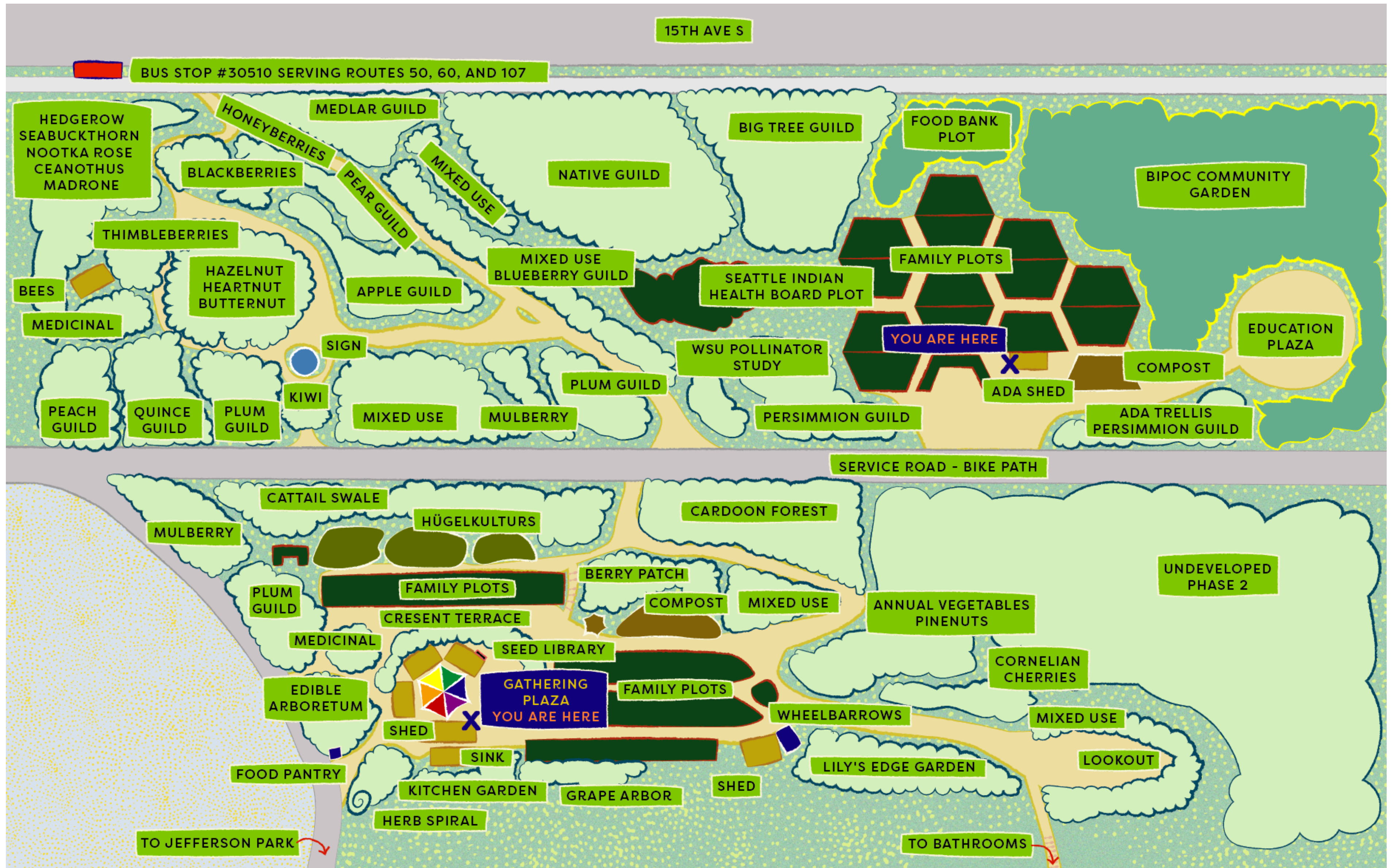

- What We Grow:**
- Annual vegetables
 - Apple
 - Artichoke
 - Aronia
 - Asparagus
 - Autumn olive
 - Blackberry
 - Blueberry
 - Boysenberry
 - Burdock
 - Butternut
 - Camas
 - Cardoon
 - Chestnut
 - Chocolate berry
 - Culinary herbs
 - Currant
 - Edible flowers
 - Elderberry
 - Fig
 - Fuki
 - Goji berry
 - Gooseberry
 - Goumi
 - Grape
 - Ground cherry
 - Hazelnut
 - Horseradish
 - Honeyberry
 - Huckleberry
 - Jostaberry
 - Kiwi
 - Maqui berry
 - Medicinal herbs
 - Medlar
 - Mulberry
 - Nettles
 - Peach
 - Pear
 - Persimmon
 - Plum
 - Quince
 - Raspberry
 - Rhubarb
 - Seabuckthorn
 - Shipova
 - Sunchoke
 - Thimbleberry
 - Wapato
 - Wineberry

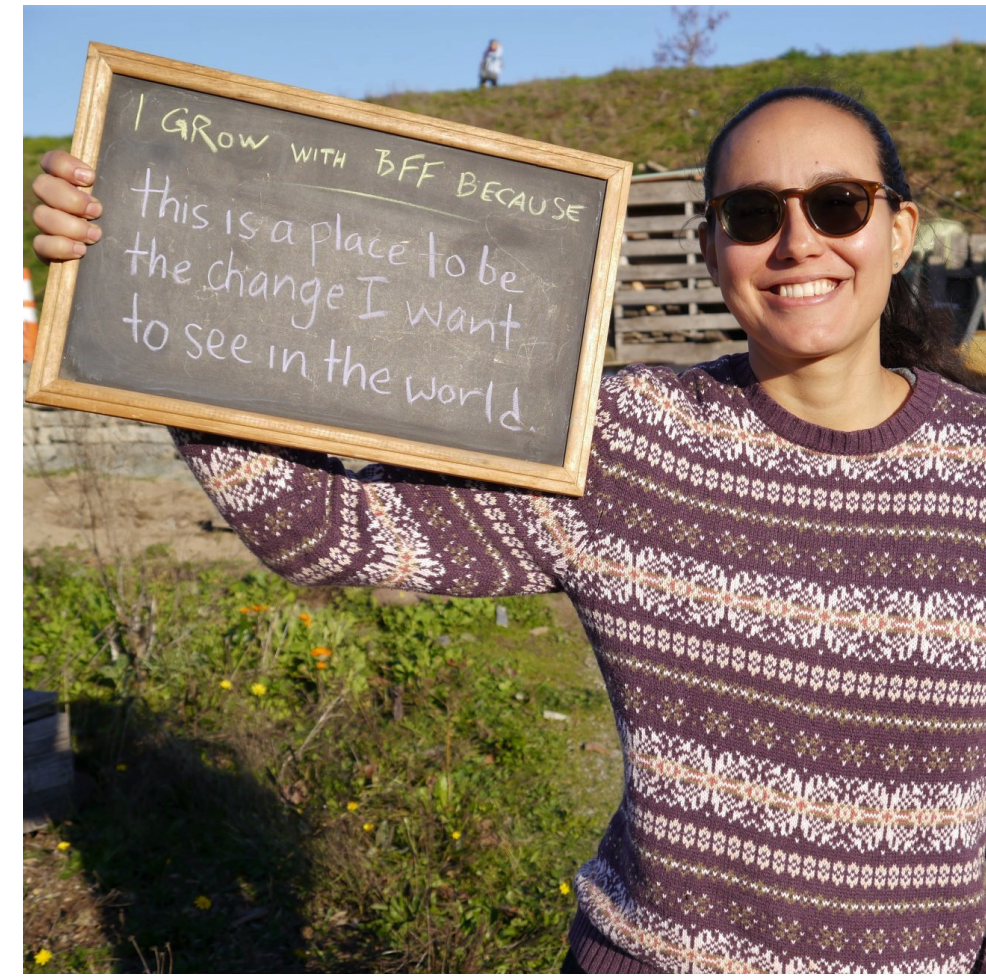

RACIAL + SOCIAL EQUITY



Our Core Values:
 Care for the Earth
 Care for the People
 Fair Share for All

Non-violent Communication
 Sociocracy Governance Model



- Our Goals:**
- Provide free, organic, and culturally-relevant food to all
 - Provide a welcoming and authentic gardening space for the diverse communities of Beacon Hill
 - Foster consistent site maintenance and development from mainly volunteers
 - Construct increasingly accessible infrastructure
 - Establish long-term financial stability for the non-profit
 - Expand the cultivated land to the total 7 acres

Our Projects:
BIPOC Community Garden

- Food Bank Plot, serving:**
- BIPOC Food Bank
 - Rainier Valley Food Bank

- BIPOC Land Shares, with:**
- Seattle Indian Health Board
 - Percussion Farms

- Seattle DON Food Equity Fund Grant, funding:**
- Two staff people
 - Expansion of site by 1-1.5 acres

ACCESSIBLE DESIGN

ADA-accessible raised beds, tool shed, vine trellises, and pathways

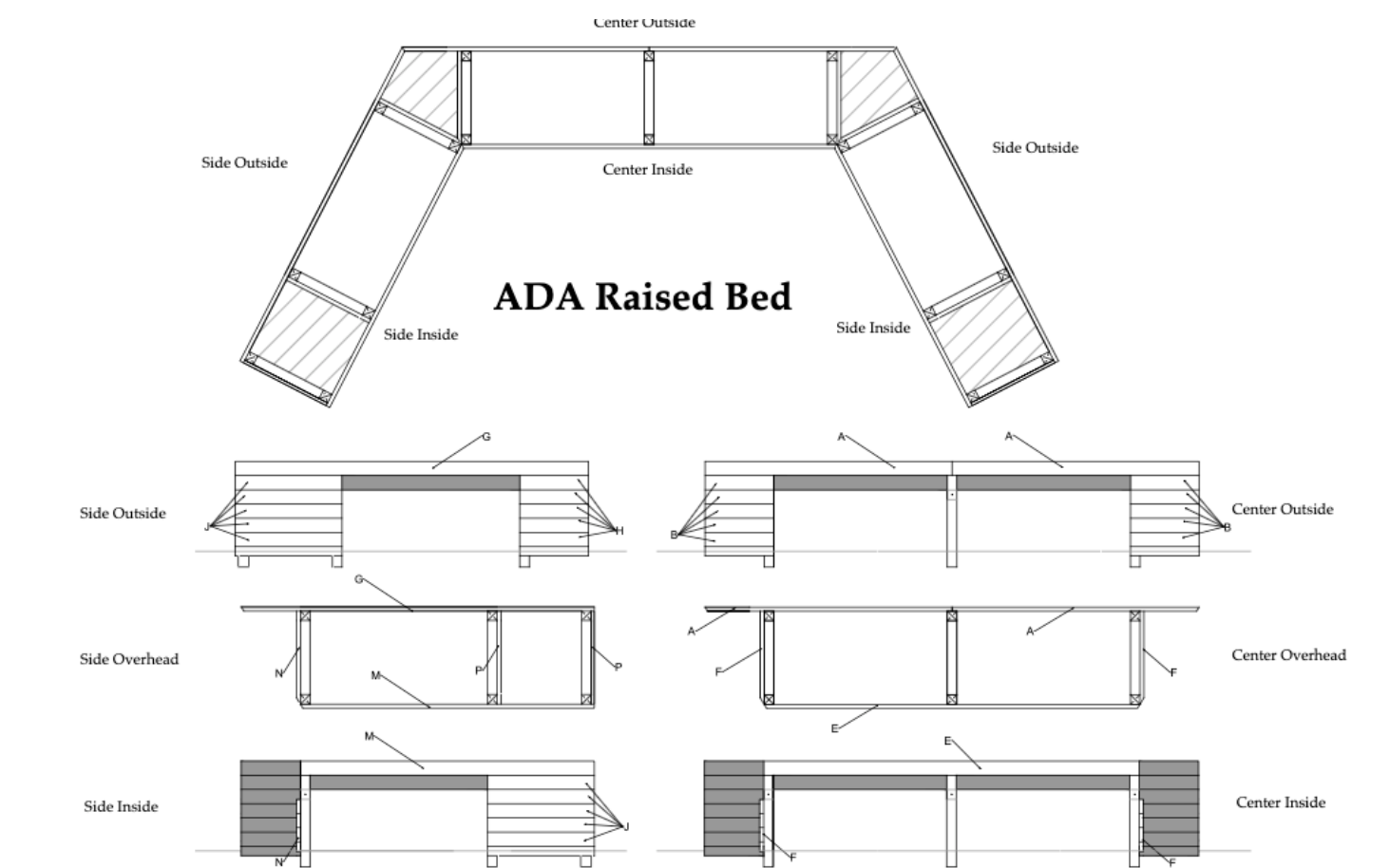

Multi-lingual Signage



**A BRIGHTER FUTURE
 FOR PEOPLE AND PLANET
 FROM THE HEART OF
 SEATTLE**

REGENERATIVE + RESILIENT

No pesticides, herbicides, fungicides, or chemical fertilizers

Recycled, salvaged, and bio-degradable materials like urbanite and burlap

Native wetland and prairie with wildlife habitat

Drought-tolerant, resilient, and climate-ready plantings

