

# Filling the Void

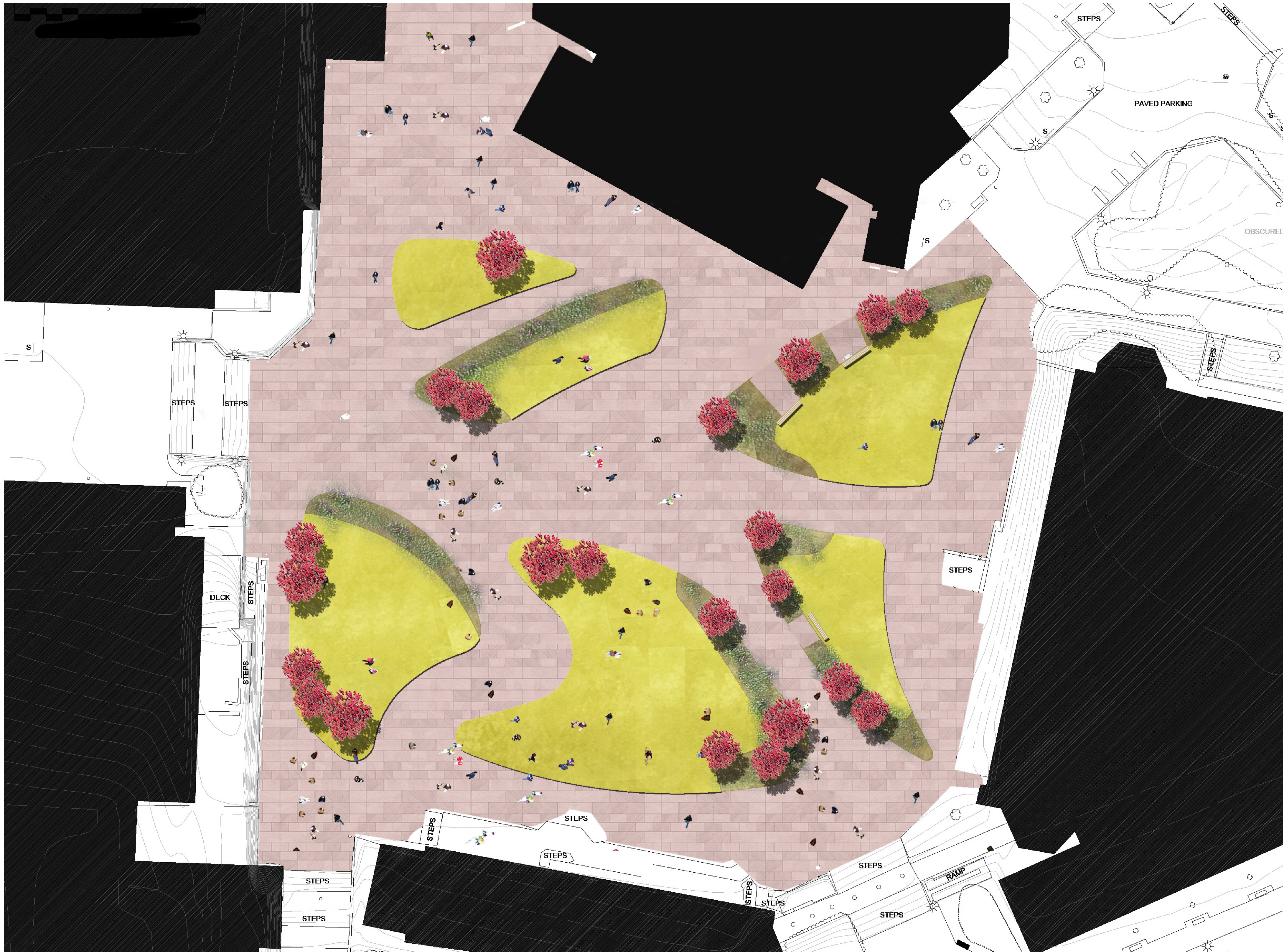

## Voids within a Void

Our plan was designed with crossroads in mind. Red Square holds thousands of people each day so we wanted to break up the traditional open space by placing voids within voids. By highlighting the most important paths these shapes emerged from the work. Spots anyone can enter to rest up, bask in the sun or gather large groups. Each shape compliments the buildings it sits across from.



## Administration Void

Standing between the Suzallo mound and Kane Hall one looks thru the two voids to view the walkway and grade change that the mounded voids produce. Each pairing of voids creates a small vista to enjoy the characters each building has to offer.

## Palette



Grass seating facing south for easy sun bathing access.



Modern wooden benches to admire Suzallo Library.

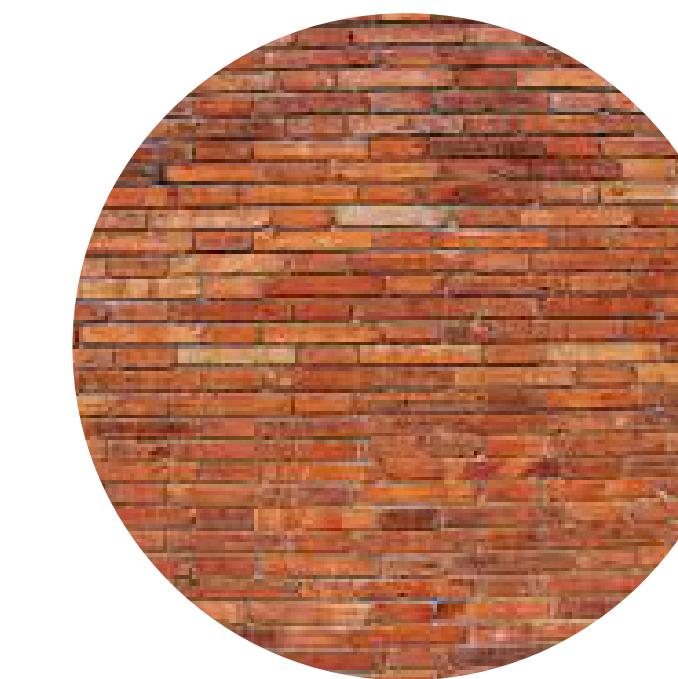

Traditional red brick with a rough coating to prevent slippage.



Cornus sericea - Red Twig Dogwood



Carex comans - New Zealand Hair Sedge



Pennisetum alopecuroides - Chinese fountain grass



Helictotrichon sempervirens - Blue oat grass



Bench wood.