

UNIVERSITY CISTERN

Red Square and the first floor of the parking structure beneath are transformed into a site for water collection and lush floating wetlands, holding the university's non-potable water needs. Surrounding public gathering spaces and buildings are connected with a network of ADA-accessible catwalks floating above water and vegetation.

PLAN

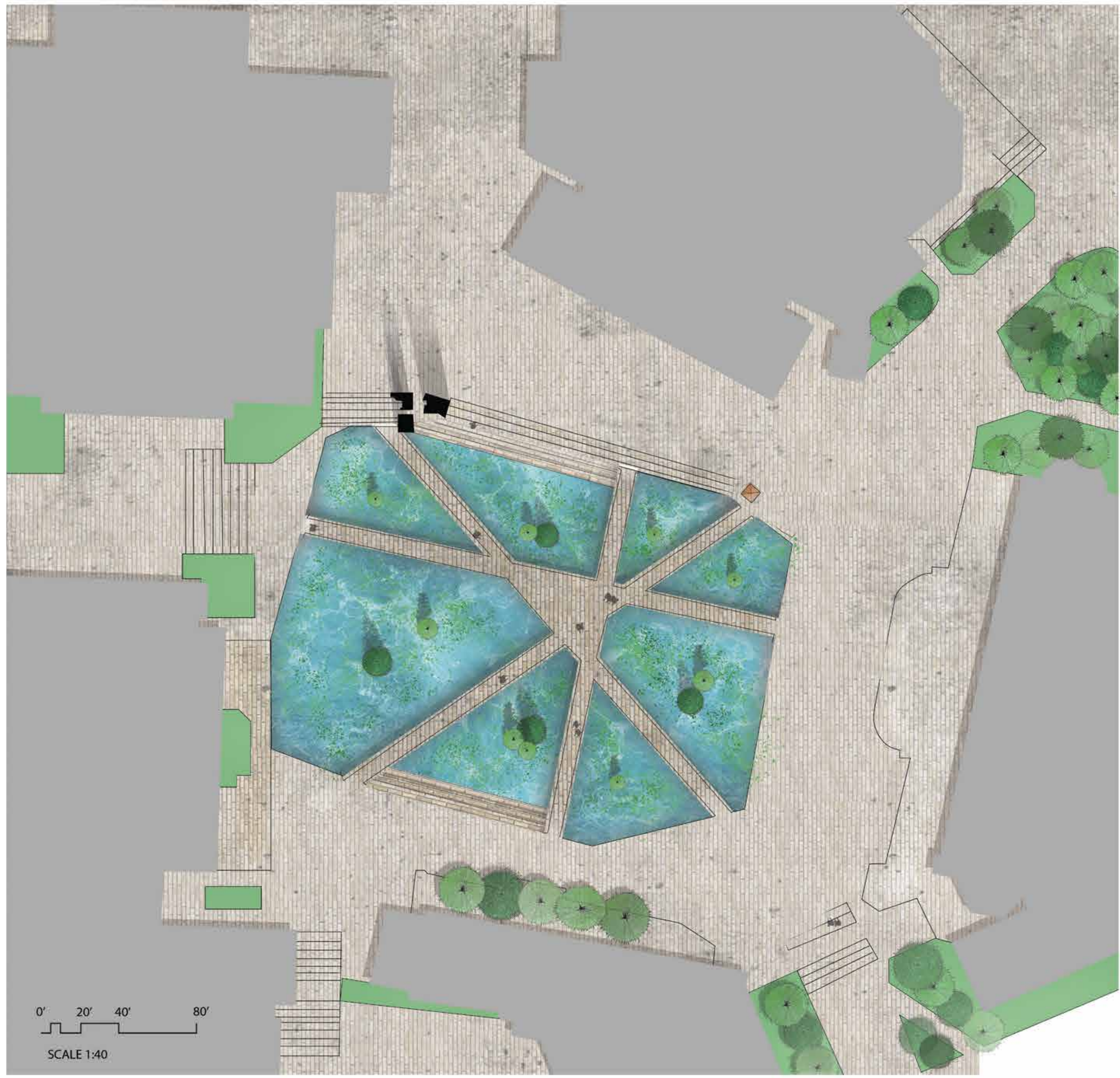

VIGNETTES

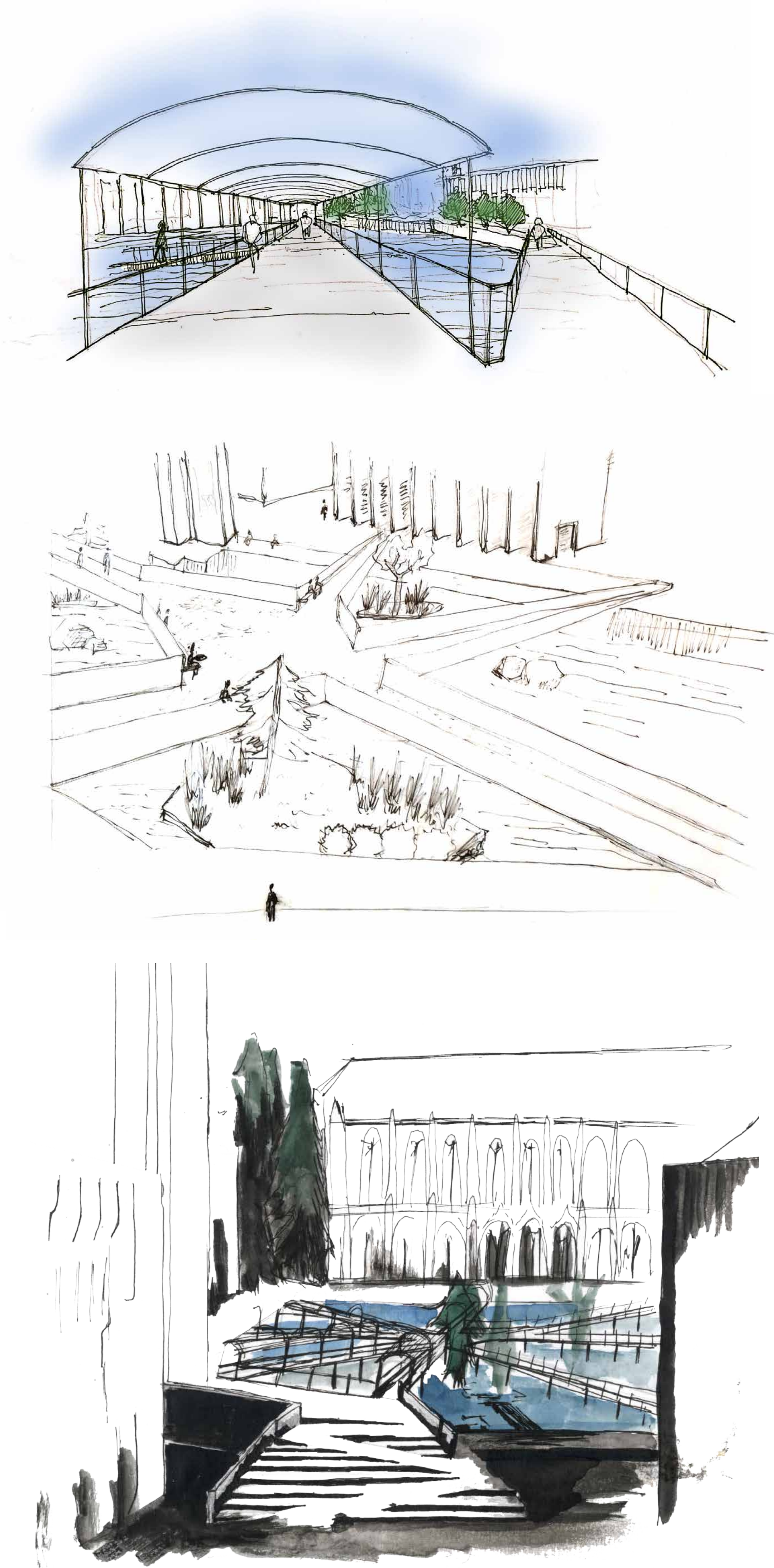

PRECEDENTS

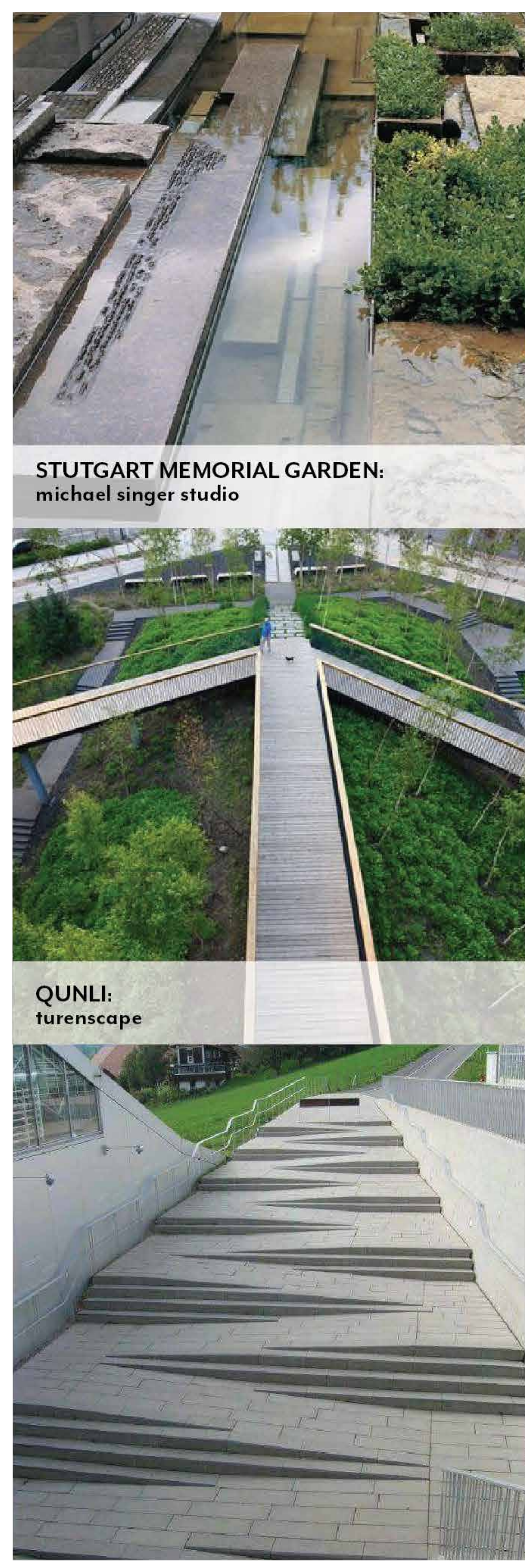

FLOATING WETLAND

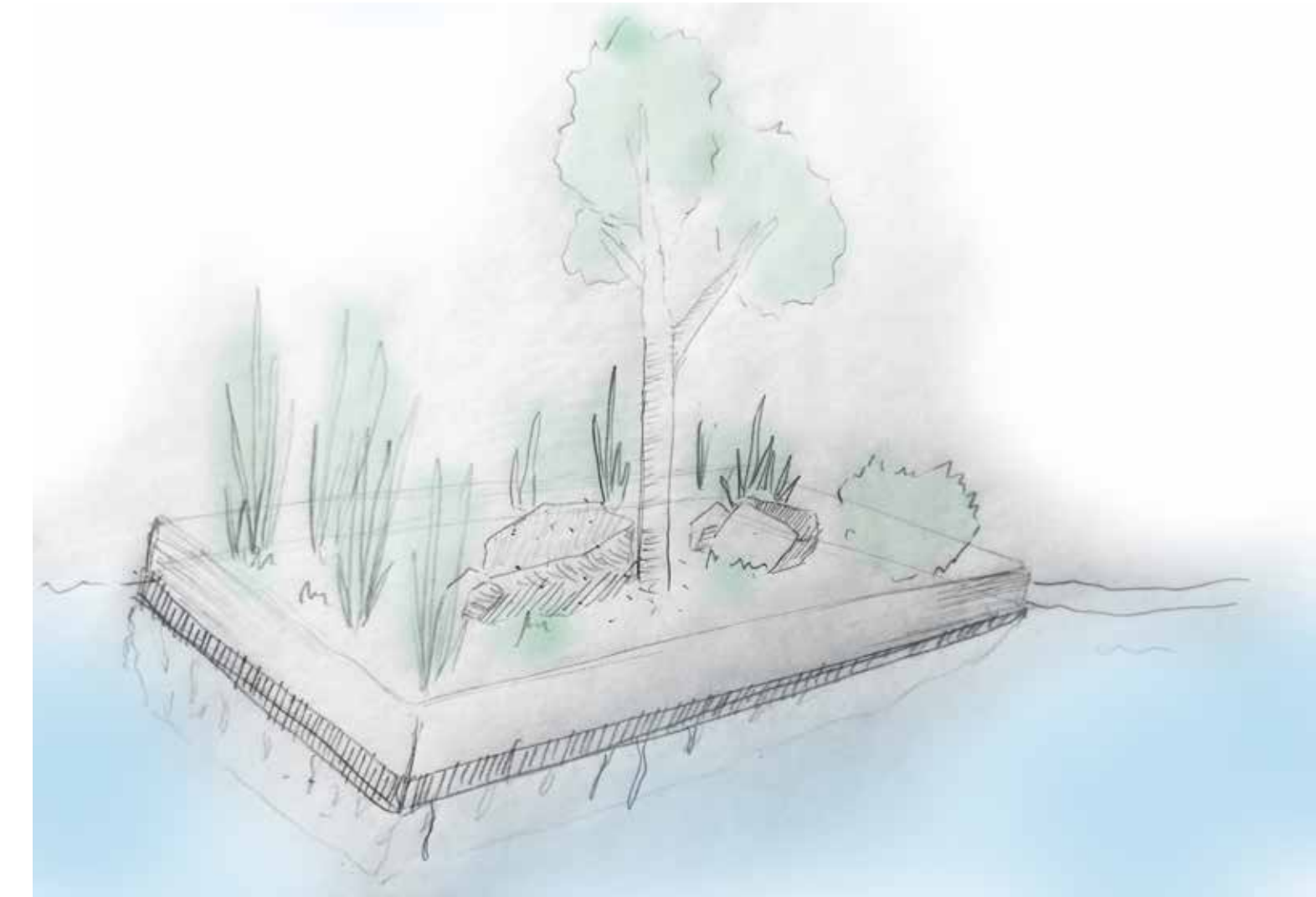

SECTION

